

HOLLYWOOD

LIVE THE REAL HOLLYWOOD DREAM



Join our exclusive online community
facebook.com/universalcaravans

UNIVERSALCARAVANS.COM.AU

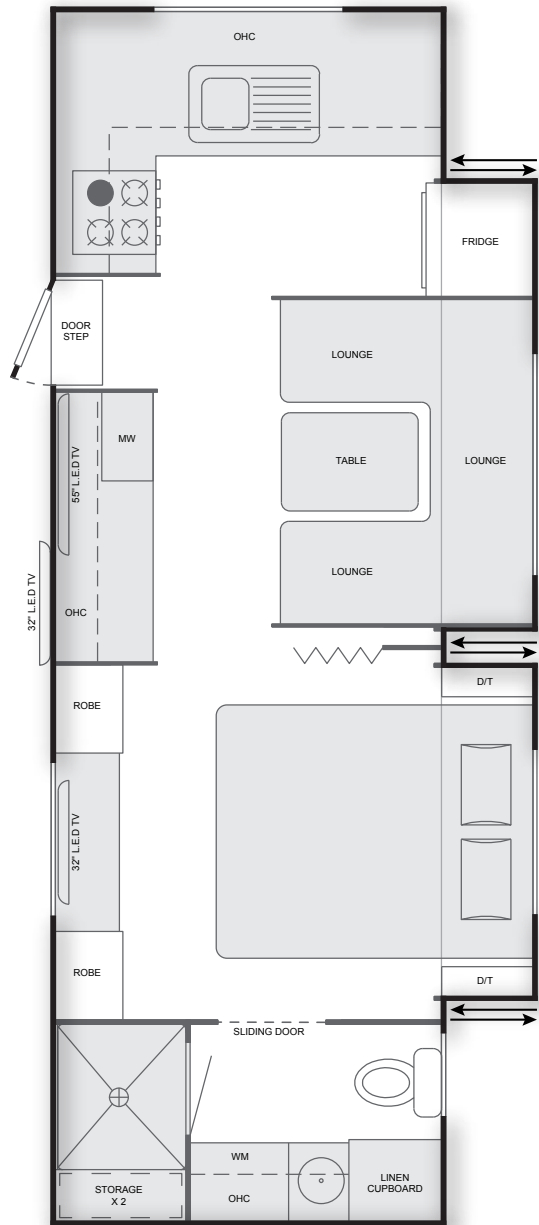

EXTERIOR

- 3A German marine-grade composite panel
- Thick checkerplate body armour
- Highest quality vinyl decals
- Euro tinted windows / double glazed
- 12V Dometic electric awning
- Awnings for slide out
- Drop down picnic table
- Toolbox on A-frame with drop down doors
- Entertainment hatch incl 32" Samsung HD LED TV outside
- 12V Hatches with light
- Pressure hatch

ELECTRICAL

- 30A REDARC battery management system
- 1000W REDARC inverter
- 2 x 120Ah Premium AGM deep cycle batteries
- 2 x 170W Solar panels
- 12V Outlets
- Internal & external speaker units
- Rear reversing camera
- Complete LED lighting
 - Downlights
 - Reading lights
 - Annexe lights
 - Boot lights
- Hafele entrance light

INTERNAL

- Slide out lounge area**
- Slide out bed**
- Modern & contemporary furniture with Lotus Caravans unique interlocking cabinetry
- Italian leather lounge upholstery
- Premium range of Laminex Diamond Gloss laminate bench tops
- Residential grade soft close drawers with solid side support
- European-made vinyl floor
- Structural grade one-piece timber floor base
- Slatted bed frame on gas struts
- Concertina door
- Pillowtop mattress
- Telescopic table leg

CHASSIS

- Torflex independent suspension
- Lotus Caravans exclusive truss chassis
- New look charcoal chassis
- DO 45 + heavy duty chain
- BF Goodrich's toughest AT tyres on exclusive 17" Lotus Caravans wheels
- Bumper bar - 2 arm
- Electric aluminium step
- Tow plug 12 pin with Anderson included
- Drop Down Jacks
- 6" A-frame

APPLIANCES

- Fusion series entertainment unit - AM/FM/CD/DVD/Bluetooth/USB/AUX x 2/ iPod/iPhone
- 2 x 32" Samsung HD LED TV
- 1 x 55" Samsung HD LED TV
- Samsung Blu Ray player
- Bose sound system
- Thetford gas / 240V oven
- Stainless slimline rangehood
- 218L 12V Compressor fridge
- Microwave
- Washing machine
- Reverse cycle air-con & heating slimline unit
- Winegard HD sensor antenna
- Full safety pack (Fire ext, smoke & gas alarm)

PLUMBING

- 2 x 62L Water tanks
- Dual mixer tap
- Tap on A-frame
- 12V Water pump
- Large kitchen sink
- Ceramic toilet bowl
- 2 x 9kg Gas bottles
- Water level indicator
- Large gas / electric HWS
- Gas bayonet
- External shower